

Bluetooth®Rear-View Mirror Handsfree Kit

VOSSOR SFK411

VOSSOR



User' s Manual

- Be sure to read this user manual before using the VOSSOR.
- Please keep this manual as it may be useful later.



Supports handsfree & headset profile

VOSSOR can be used as a handsfree unit or a headset as the situation demands.

Excellent voice tone

You can have a conversation without noise and feedback.

Caller ID display

You can identify the Caller ID of an incoming call.

Contents

Preparation

Features	1
Part description.....	2
Button functions.....	3

How to use

Configuration	4
·Charging battery with Cigar lighter adapter	4
·Setting up VOSSOR	5
·Setting up Battery	5
·Using earphone(option)	5
·Options for power supply.....	6
·Power on	7
·Power off	7
·Speaker Volume control	7
·Microphone Volume control.....	7
·Speaker mute	7
Pairing with a Bluetooth mobile phone	8
Using VOSSOR	9
·Last number/Voice dialing	9
·Answering a call	9
·Ending/Rejecting a call	9
·Transferring audio	9
·Call Waiting	9

Reference

Troubleshooting.....	10
Precautions.....	11
Specifications	12

Front

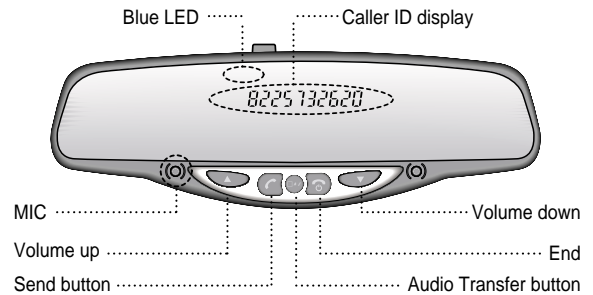

Back

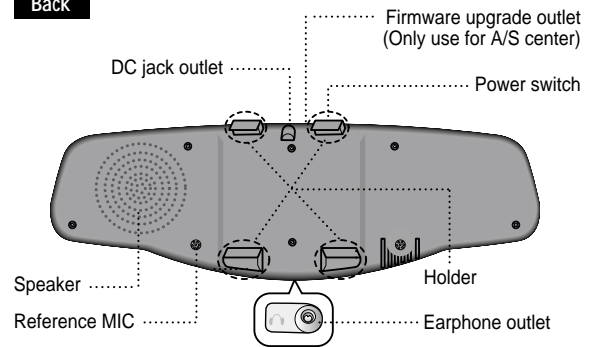

Included Accessories

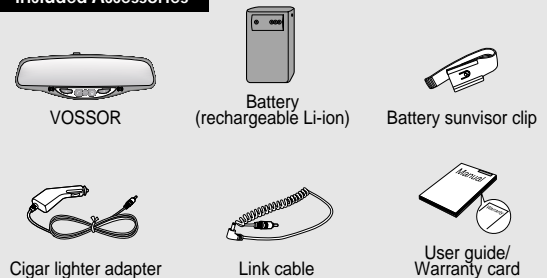



For the best results, fully charge the battery prior to initial use.

Function	VOSSOR Status	How to use button	Supporting profile	
			Handsfree	Headset
Pairing mode		Press and Hold	Y	Y
Last number called		Press	Y	Y
Voice dialing (Only when user's mobile phone supports this function.)		Press and Hold	Y	N
Answering a call	Ringing	Press	Y	Y
Rejecting a call	Ringing	Press	Y	N
Ending a call	Talking	Press	Y	Y
Transferring audio (Handset -> VOSSOR)	Talking	Press	Y	Press
Transferring audio (VOSSOR -> Handset)	Talking	Press	Y	Consult with your phone manual
Volume increase		Press	Y	Y
Volume decrease		Press	Y	Y
Microphone Volume control		Press +	Y	Y
Power on		Switch	Y	Y
Power off		Switch	Y	Y

First,

The battery is not charged when it is first delivered to the user. Charge the battery with the provided charger before using VOSSOR.

Charging the battery with Cigar lighter adapter

1 Connect the Cigar lighter adapter to a power outlet.

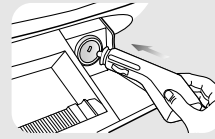

2 Connect the Cigar lighter adapter to VOSSOR.

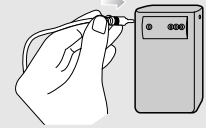

Tips • It takes about 4 hours to fully charge the battery.

External Battery LED Indication I

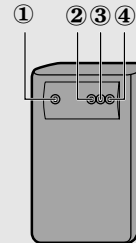

Charger Connected

- LED-Red Off : Done or suspend
On : Charge-in-progress
 - LED-Green On : Full
 - LED-Yellow On : Medium
 - LED-Red On : Low
- ※LED - Green/Yellow/Red (all 2,3,4 On) : Full

LED Indicator

- LED-Red Off : not under charging status
- LED-Green Off : Medium
- LED-Yellow Off : Low
- LED-Red Off : Discharged



Configuration

Setting up VOSSOR

First, place the upper holder of VOSSOR to the top side of the rear-view mirror in your car. Push VOSSOR closely to the mirror and place the lower holder of VOSSOR to fit completely.

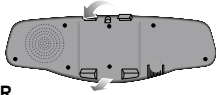

Tips Place VOSSOR in the center of the rear-view mirror in your car. If not, the sound could be diminished.

Setting up the Battery

1 Put the enclosed battery clip in the groove on the lower side of the battery.



2 Fix the battery using the enclosed clip.

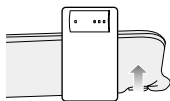

Using the earphone(Option)

You can have a private conversation with the earphone. For this function, please make the speaker mute by double clicking the Audio Transfer button(A/T). Please refer to the Page 7 for Speaker mute.



Options for power supply

You can select an option out of as below;

Option1 VOSSOR+Battery

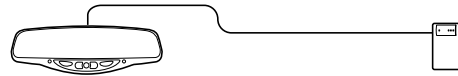

The first time you use VOSSOR, please fully recharge the battery first.

Option2 VOSSOR+Battery+Cigar lighter adapter

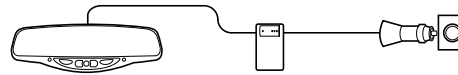

Option3 VOSSOR+Cigar lighter adapter





Configuration



Pairing with a Bluetooth mobile phone

After pairing the Bluetooth mobile phone with VOSSOR, you can use it as a handsfree unit.

Power on

Turn on the Power switch.

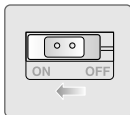

Power off

Turn off the Power switch

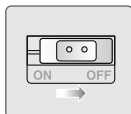

Speaker Volume control

- For higher volume, press ▲ button .
- For lower volume, press ▼ button.

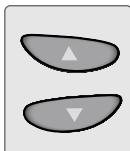

Microphone Volume control

In order to increase the volume of the microphone, press SEND and END button simultaneously until you hear the "beep" sound.

- Repeat four times to go back to initial stage.



Speaker mute

Double click the Audio Transfer button.

- The speaker will mute after the beep sound is heard. (The sound will still be heard through the earphones.)
- To cancel the mute function, double click the Audio Transfer button.



1 Press the END button for more than 2 seconds.

- The blue LED will flash once a second with a melody.



2 From the handset, search for and register VOSSOR.

- Please refer to the user's manual of the handset.
- Enter "0000" when a pincode(or passcode) is requested.
- when the pairing is completed, the blue LED of VOSSOR flashes every 4-5 seconds with a melody. If it flashes once a second, please try again from the beginning.



Tips

- Once your phone is paired with VOSSOR, it will automatically recognize VOSSOR.

Pairing can be done with up to a maximum of 3 handsets.

- VOSSOR stores up to 3 different phones in memory.
- Keep in mind that the latest phone number removes the earliest one when the memory is full.
- Priority is given to the most recently paired handset.
- If you want to change the handset priority, try to connect VOSSOR from the handset.
- If the latest paired handset supports handsfree profile, VOSSOR is connected automatically to the handset when the power is on.



Last number/Voice dialing

You can have a conversation with VOSSOR and use it as a handsfree unit.

Press SEND button.

- You can re-dial the latest number by pressing this button. (In the case of some handsets, voice dialing initiates)
- You can activate the voice dialing by holding this button. (If the handset supports this function)



Answering a call

VOSSOR plays a melody and the blue LED flashes when a handset rings.

Press SEND button to answer a call.

- You can have a conversation through VOSSOR.



Ending/Rejecting a call

Press END button to end/reject a call.



Transferring audio

Handset ⇒ VOSSOR : Press Audio Transfer button of VOSSOR while you are talking.

- It can be transferred to VOSSOR without ending a call.

VOSSOR ⇒ Handset : Press Audio Transfer button of VOSSOR while you are talking.

- It can be transferred to the handset without ending a call.



Call Waiting

To receive a second call while answering the first call, press Send Button of the Vossor.

- To get back to the first call, just press Send Button again.



VOSSOR does not turn on.

Check Whether the battery of VOSSOR is fully charged. ⇨ Charge the battery.

Check Whether the Power cable is inserted properly. ⇨ Insert cable again.

Check Whether the Power switch is turned on. ⇨ Turn on Power switch.

Can not have a conversation through VOSSOR.

Check Whether the handset supports handsfree profile. ⇨ In order to have a conversation through VOSSOR, a Bluetooth handset that supports handsfree profile is required.

Check Whether the battery of VOSSOR is low. ⇨ Charge the battery.

Can not pair VOSSOR with the Bluetooth device.

Check Whether the power of VOSSOR is turned on. ⇨ Turn on the Power switch or insert the Power cable.

No sound from the speaker.

Check Whether the volume status is at lower level. ⇨ Press the Volume up button.



Precautions



Specifications

Do not drop the unit from high places.



Do not modify, repair nor take apart at discretion.



Do not expose directly to the water, alcohol, benzene, etc. for cleaning.

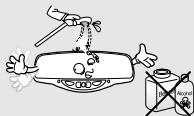

Do not expose directly to flammables.

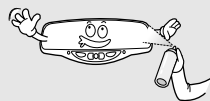

Do not disassemble the battery.
· It may cause an explosion.

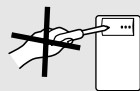

Do not place nor keep the unit near the flammables.
· It may cause an explosion.



Keep the device away from humidity & dust.

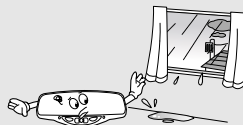

Do not place heavy objects on the device.

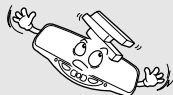

Keep away from direct light or heat.



· Changes or modifications not expressly approved by the party responsible for compliance could void the user's authority to operate the equipment.

· The device may explode if the battery is replaced incorrectly.

· Dispose the used batteries according to the instructions.



Function	Description
Ear Phone Interface	Ear Phone Type
Battery	3.7V, 2000mA Li-Ion
Speaker	4 Ω / 1W(Normal)
MIC	-47 +/- 1.5dB
Power Consumption	Max 250mA
Cigar Lighter Jack	OUT : 5V/600mA
Frequency range	2400MHz to 2483.5MHz (USA, Europe)
Modulation Method	GFSK, 1Mbps, 0.5BT Gaussian
Transmission Power	Typ. 1.0dBm
Hopping	1600 hops/sec, 1MHz channel space
RX. Sensitivity	Typ. -83.0dBm
Built in Memory	Flash memory(4MBit)
Operating Temperature	-20~70°C
Storage Temperature	-40~80°C
Noise suppression	<52dB
Echo Cancellation	Up to 18dB
Supported Profile	Headset and Handsfree
Security Level	Level 3
Standby Time	200 hours
Talking Time	10 hours



Memo

A large rectangular area with a rounded border, containing 25 horizontal dotted lines for writing.

Notes

Several studies have shown that cell phone usage while driving creates a distraction to the driver which may increase the likelihood of an accident. This distraction potential is not eliminated by the use of a handsfree kit. handsfree kits have not been shown to be safer than hand-held phones with respect to driver distraction. When using the phone while driving, keep conversations short and resist any temptation to make notes or read documents. Before answering calls consider your circumstances. Pull off the road and park before making or answering calls when driving conditions require (e.g. bad weather, high traffic density, presence of children in the car, difficult junctions or manoeuvres.)

Abide by local laws.

Please check if the state and local laws where you live restrict the use of mobile phones while driving. It is the owner's responsibility to use this product in compliance with the laws of the place where you live.